

GEARCASE COMPONENTS (MODELS BF75A AND BF90A)

- | | | |
|----------------------------|------------------------------------|--------------------------------|
| 1. Water tube seal/guide | 31. Bearing race | 60. Washer |
| 2. Bolt | 32. Roller bearing | 61. Nut |
| 3. Washer | 33. Gearcase housing | 62. Needle bearing |
| 4. Sleeve | 34. Gasket | 63. Inner propeller shaft seal |
| 5. Water pump body | 35. Gear lubricant vent/plug | 64. Outer propeller shaft seal |
| 6. Impeller | 36. Gear lubricant vent/plug | 65. Thrust washer |
| 7. Drive key | 37. Gear lubricant drain/fill plug | 66. Propeller |
| 8. Gasket | 38. Pinion nut | 67. Tab washer |
| 9. Wear plate | 39. Pinion gear | 68. Propeller nut |
| 10. Gasket | 40. Shift cam | |
| 11. Bolt | 41. Shim | |
| 12. Washer | 42. Bearing race | |
| 13. Water pump base | 43. Roller bearing | |
| 14. Upper drive shaft seal | 44. Needle bearing | |
| 15. Lower drive shaft seal | 45. Forward gear | |
| 16. Gasket | 46. Follow | |
| 17. Roller bearing | 47. Connector | |
| 18. Bearing sleeve | 48. Bearings (3) | |
| 19. Lubrication sleeve | 49. Spring | |
| 20. Drive shaft sleeve | 50. Clutch | |
| 21. O-ring | 51. Cross pin | |
| 22. Drive shaft | 52. Clutch spring | |
| 23. Shift shaft adapter * | 53. Propeller shaft | |
| 24. Bolt | 54. Reverse gear | |
| 25. Seal | 55. O-ring | |
| 26. Bushing | 56. Thrust bearing | |
| 27. O-ring | 57. Bearing race | |
| 28. Shift shaft | 58. Roller bearing | |
| 29. E-clip | 59. Bearing carrier | |
| 30. Shims | | |

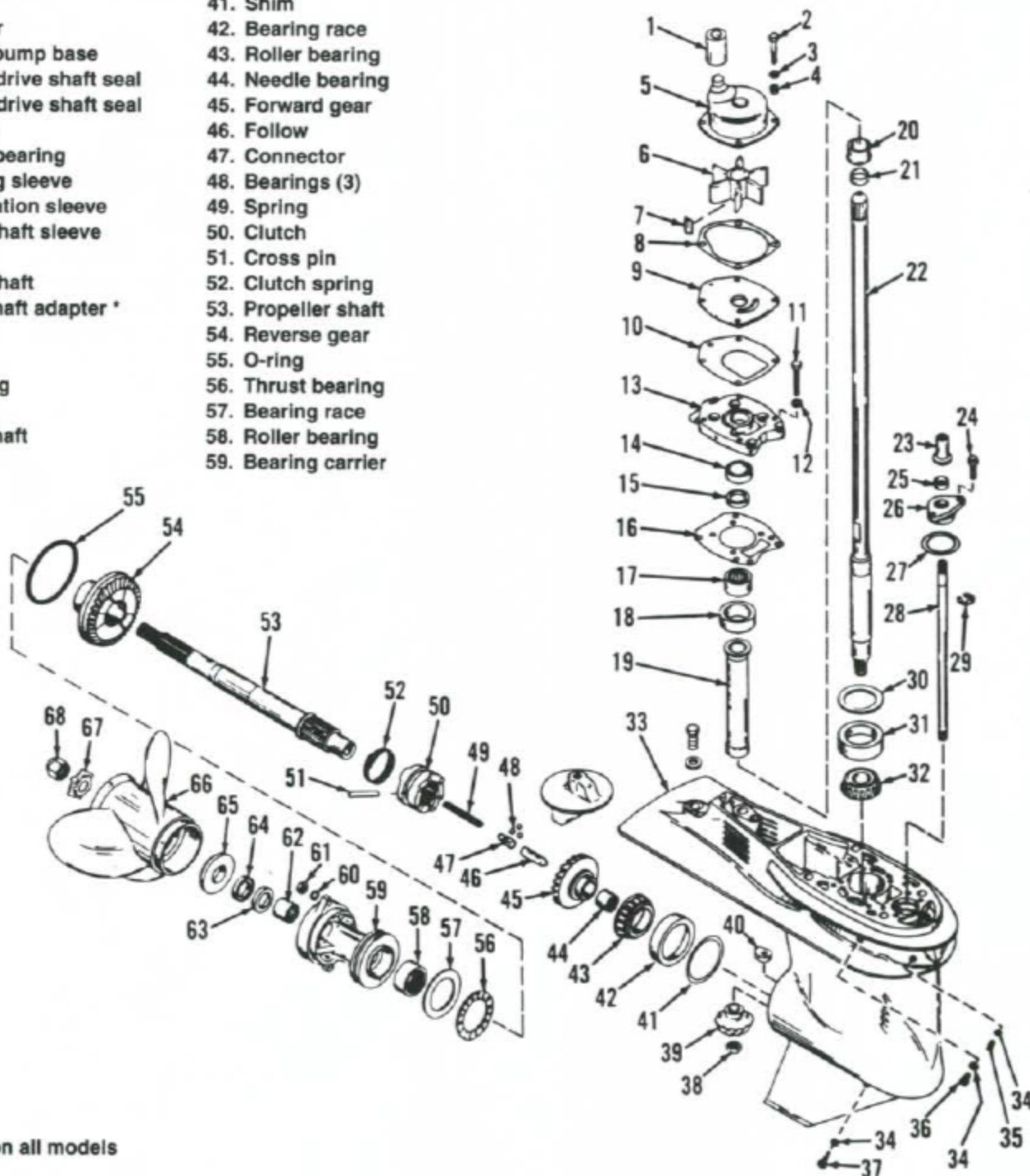

*not used on all models