

BASE ENGINE COMPONENTS (MODELS BF20 AND BF2A)

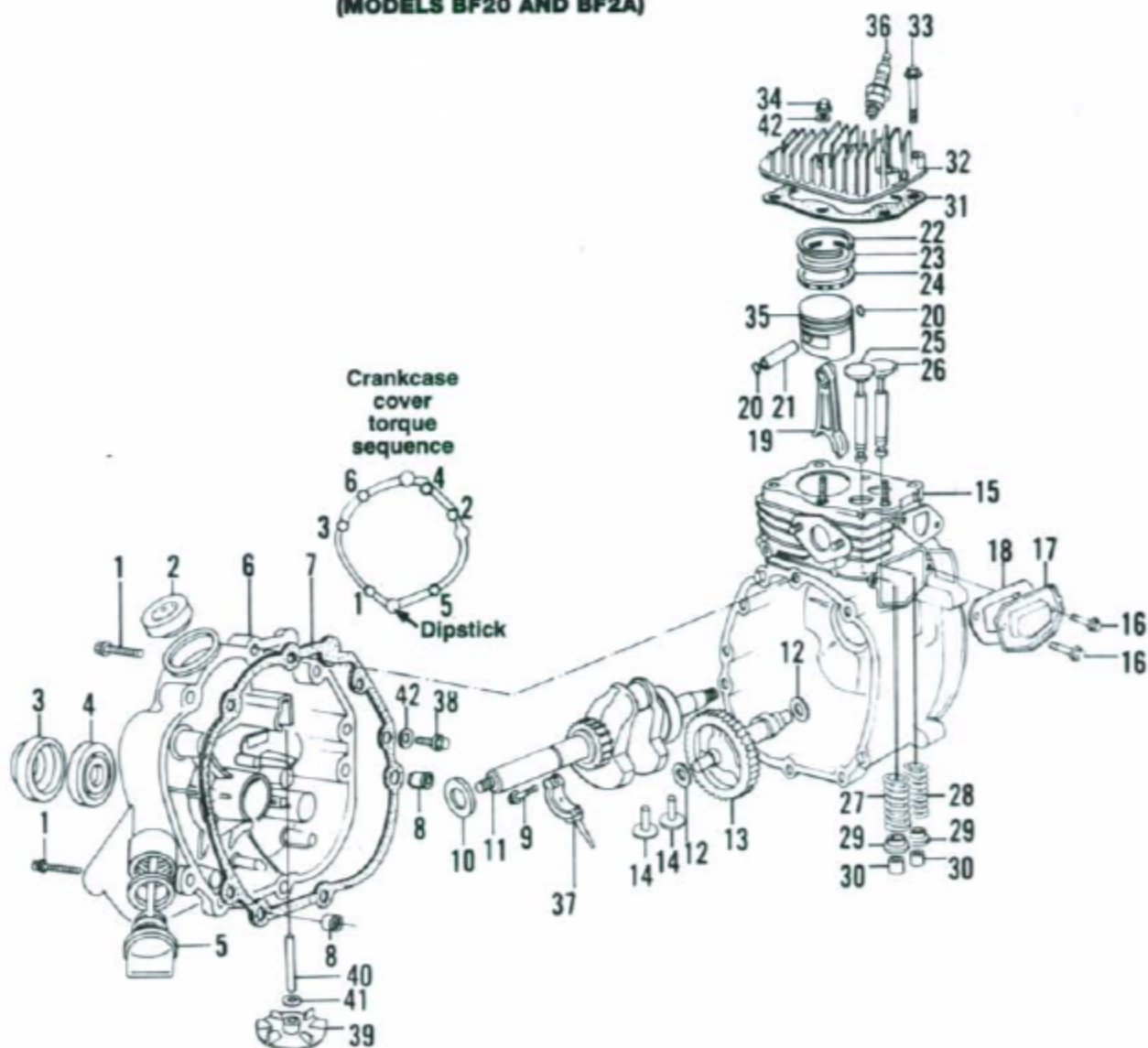

- | | |
|--------------------|--------------------------|
| 1. Bolt | 22. Top ring |
| 2. Slight window | 23. Second ring |
| 3. Collar | 24. Oil ring (bottom) |
| 4. Oil seal | 25. Exhaust valve |
| 5. Dipstick | 26. Intake valve |
| 6. Crankcase | 27. Exhaust valve spring |
| 7. Gasket | 28. Intake valve spring |
| 8. Alignment pin | 29. Spring cap |
| 9. Bolt | 30. Valve adjuster |
| 10. Thrust washer | 31. Head gasket |
| 11. Crankshaft | 32. Cylinder head |
| 12. Thrust washer | 33. Bolt |
| 13. Camshaft | 34. Nut |
| 14. Lifter | 35. Piston |
| 15. Cylinder block | 36. Spark plug |
| 16. Bolt | 37. Rod cap |
| 17. Cover | 38. Bolt |
| 18. Gasket | 39. Lubrication wheel |
| 19. Connecting rod | 40. Shaft |
| 20. Lockring | 41. Thrust washer |
| 21. Piston pin | 42. Washer |