

POWER HEAD (TYPICAL EARLY 3-CYLINDER MODEL)

1. Flywheel nut
2. Seal
3. Hex screw
4. Crankshaft bearing cage
5. Crankshaft bearing cage seal
6. Crankshaft upper bearing
7. Hex bolt
8. Hex bolt
9. Plain washer
10. Hex nut
11. Plain washer
12. Hex screw
13. Hex screw
14. Hex bolt
15. Screw
16. Flywheel key
17. Stud
18. Crankshaft
19. Crankshaft lower main bearing
20. Drain reed plate gasket
21. Screen
22. Reed
23. Drain reed plate
24. Reed stop
25. Plain washer
26. Pan head screw
27. Drain cover gasket
28. Drain cover
29. Hex screw
30. Fitting
31. Hose
32. Hex screw
33. Transfer port cover
34. Transfer port cover gasket
35. Stop nut
36. Spacer plate
37. Spring lockwasher
38. Hex bolt
39. Upper cylinder exhaust gasket
40. Forward stud
41. Cylinder and crankcase cover assembly
42. Rear stud
43. Plain washer
44. Stop nut
45. Spark plug
46. Hex bolt
47. Plain washer
48. Hex nut
49. Spring lockwasher
50. Thermostat
51. Screw
52. Thermostat cover
53. Grommet
54. Thermostat
55. Thermostat cover gasket
56. Cylinder head cover
57. Cylinder head
58. Cylinder head gasket
59. Hex bolt
60. Hex screw
61. Hex screw
62. Hex screw
63. Bypass valve cover
64. Bypass valve cover gasket
65. Bypass valve spring
66. Bypass valve
67. Exhaust port cover
68. Exhaust port plate gasket
69. Exhaust port plate

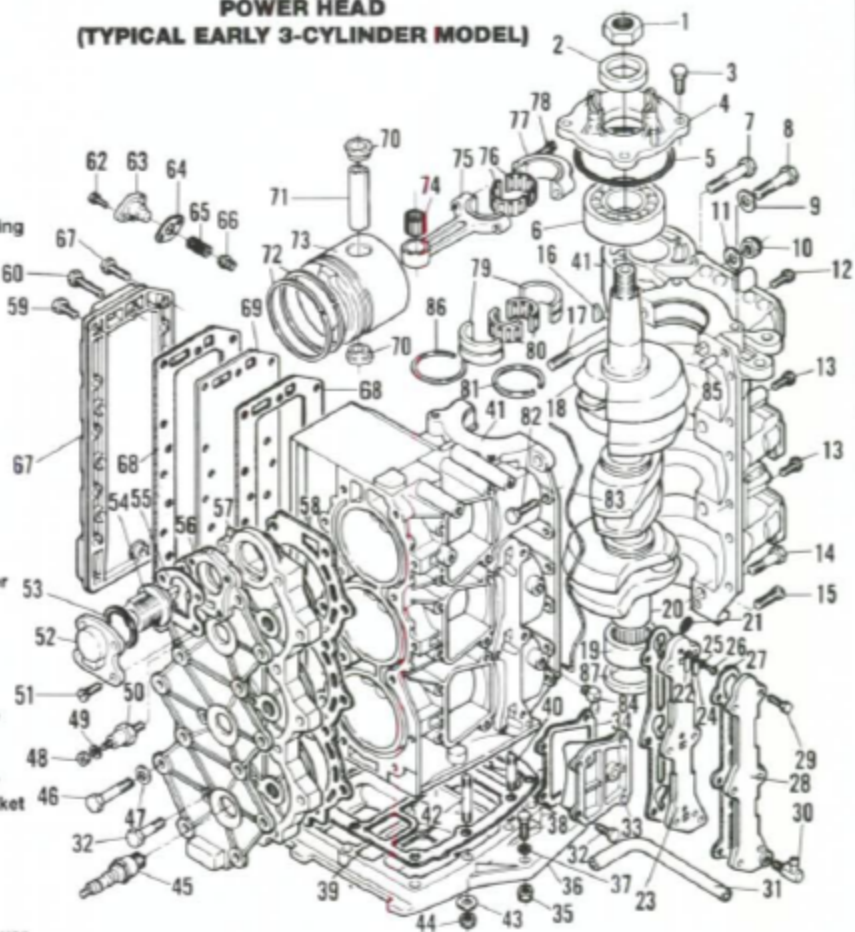

51. Screw
52. Thermostat cover
53. Grommet
54. Thermostat
55. Thermostat cover gasket
56. Cylinder head cover
57. Cylinder head
58. Cylinder head gasket
59. Hex bolt
60. Hex screw
61. Hex screw
62. Hex screw
63. Bypass valve cover
64. Bypass valve cover gasket
65. Bypass valve spring
66. Bypass valve
67. Exhaust port cover
68. Exhaust port plate gasket
69. Exhaust port plate

70. Piston pin spacer
71. Piston pin
72. Piston rings
73. Piston
74. Piston pin bearing
75. Connecting rod
76. Bearing cage and rollers
77. Connecting rod cap
78. Connecting rod cap screw
79. Crankshaft main bearing race
80. Bearing cage and rollers
81. Crankcase seal
82. Hex screw
83. Spaghetti seal
84. Elbow
85. Locating pin
86. Snap ring
87. Crankshaft lower seal