

**POWER HEAD  
(TYPICAL EARLY 4-CYLINDER MODEL)**

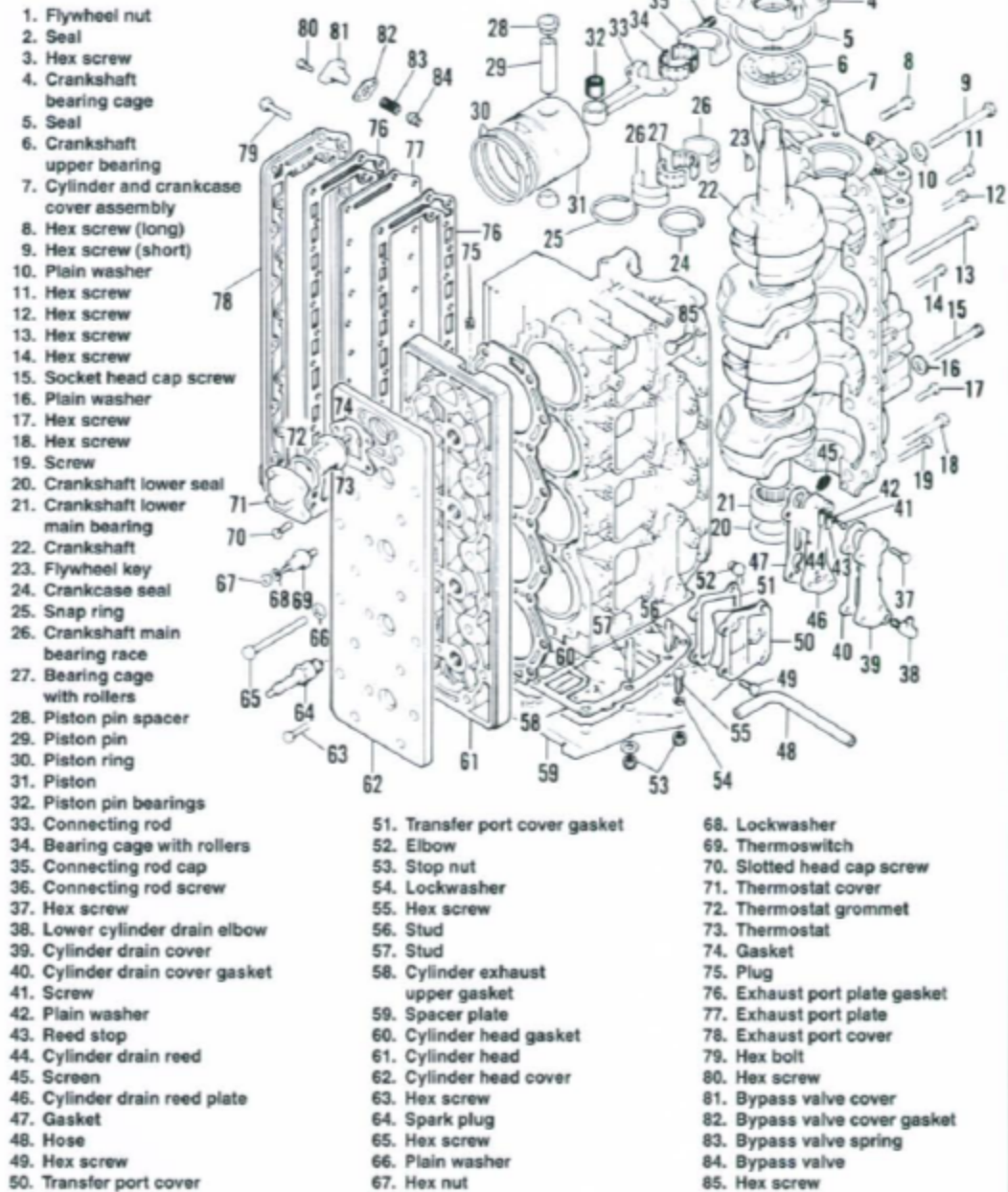

1. Flywheel nut
2. Seal
3. Hex screw
4. Crankshaft bearing cage
5. Seal
6. Crankshaft upper bearing
7. Cylinder and crankcase cover assembly
8. Hex screw (long)
9. Hex screw (short)
10. Plain washer
11. Hex screw
12. Hex screw
13. Hex screw
14. Hex screw
15. Socket head cap screw
16. Plain washer
17. Hex screw
18. Hex screw
19. Screw
20. Crankshaft lower seal
21. Crankshaft lower main bearing
22. Crankshaft
23. Flywheel key
24. Crankcase seal
25. Snap ring
26. Crankshaft main bearing race
27. Bearing cage with rollers
28. Piston pin spacer
29. Piston pin
30. Piston ring
31. Piston
32. Piston pin bearings
33. Connecting rod
34. Bearing cage with rollers
35. Connecting rod cap
36. Connecting rod screw
37. Hex screw
38. Lower cylinder drain elbow
39. Cylinder drain cover
40. Cylinder drain cover gasket
41. Screw
42. Plain washer
43. Reed stop
44. Cylinder drain reed
45. Screen
46. Cylinder drain reed plate
47. Gasket
48. Hose
49. Hex screw
50. Transfer port cover

51. Transfer port cover gasket
52. Elbow
53. Stop nut
54. Lockwasher
55. Hex screw
56. Stud
57. Stud
58. Cylinder exhaust upper gasket
59. Spacer plate
60. Cylinder head gasket
61. Cylinder head
62. Cylinder head cover
63. Hex screw
64. Spark plug
65. Hex screw
66. Plain washer
67. Hex nut

68. Lockwasher
69. Thermostat cover
70. Slotted head cap screw
71. Thermostat cover
72. Thermostat grommet
73. Thermostat
74. Gasket
75. Plug
76. Exhaust port plate gasket
77. Exhaust port plate
78. Exhaust port cover
79. Hex bolt
80. Hex screw
81. Bypass valve cover
82. Bypass valve cover gasket
83. Bypass valve spring
84. Bypass valve
85. Hex screw