

CYLINDER HEAD COMPONENTS (MODELS BF75, BF8A AND BF100)

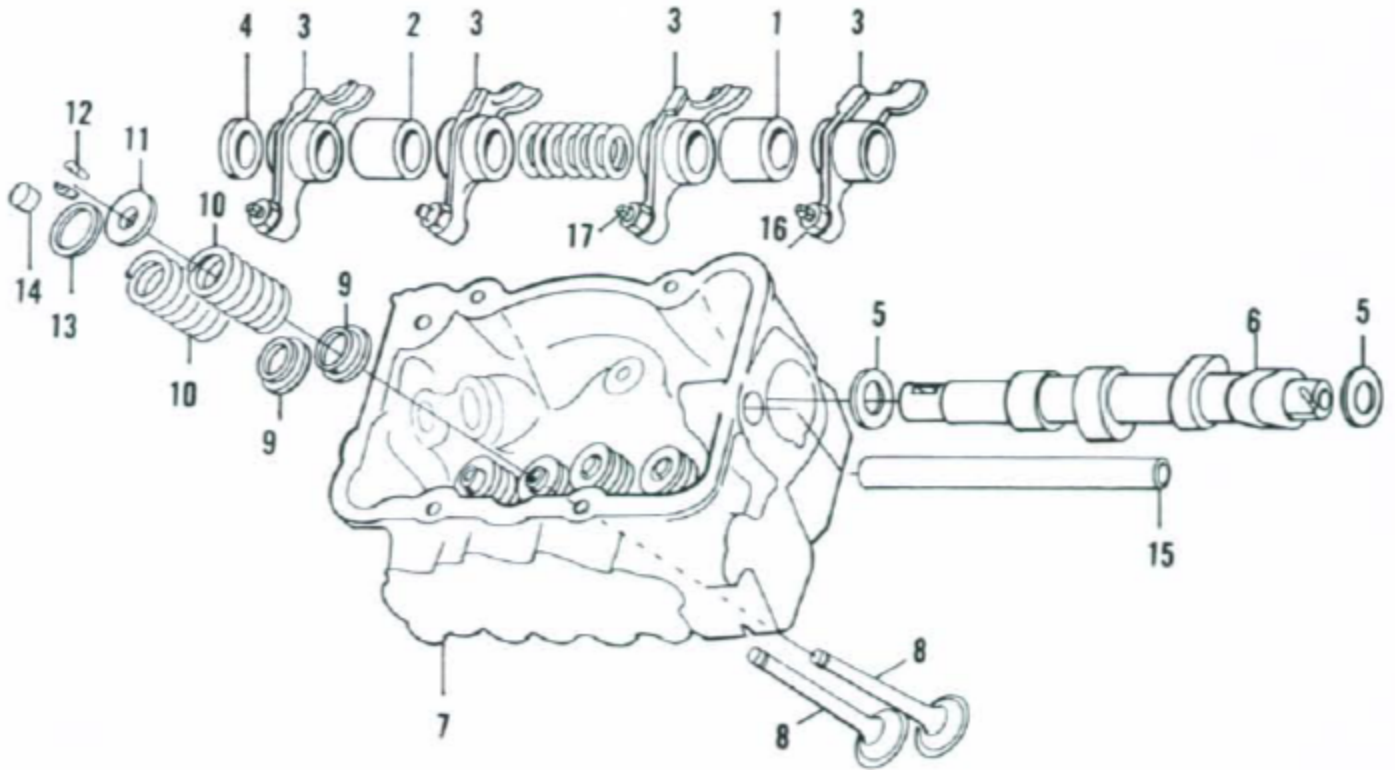

- | | |
|------------------|--------------------------|
| 1. Spacer | 10. Spring |
| 2. Spacer | 11. Spring cap (intake) |
| 3. Rocker arm | 12. Keepers |
| 4. Collar | 13. Spring cap (exhaust) |
| 5. Thrust washer | 14. Valve rotator |
| 6. Camshaft | 15. Rocker arm shaft |
| 7. Cylinder head | 16. Locknut |
| 8. Valve | 17. Adjusting screw |
| 9. Spring base | |