

**CRANKSHAFT ASSEMBLY (65 JET AND 75-125 HP
[EXCEPT 105 JET AND 115 HP OPTIMAX] MODELS)
(FOUR CYLINDER SHOWN)**

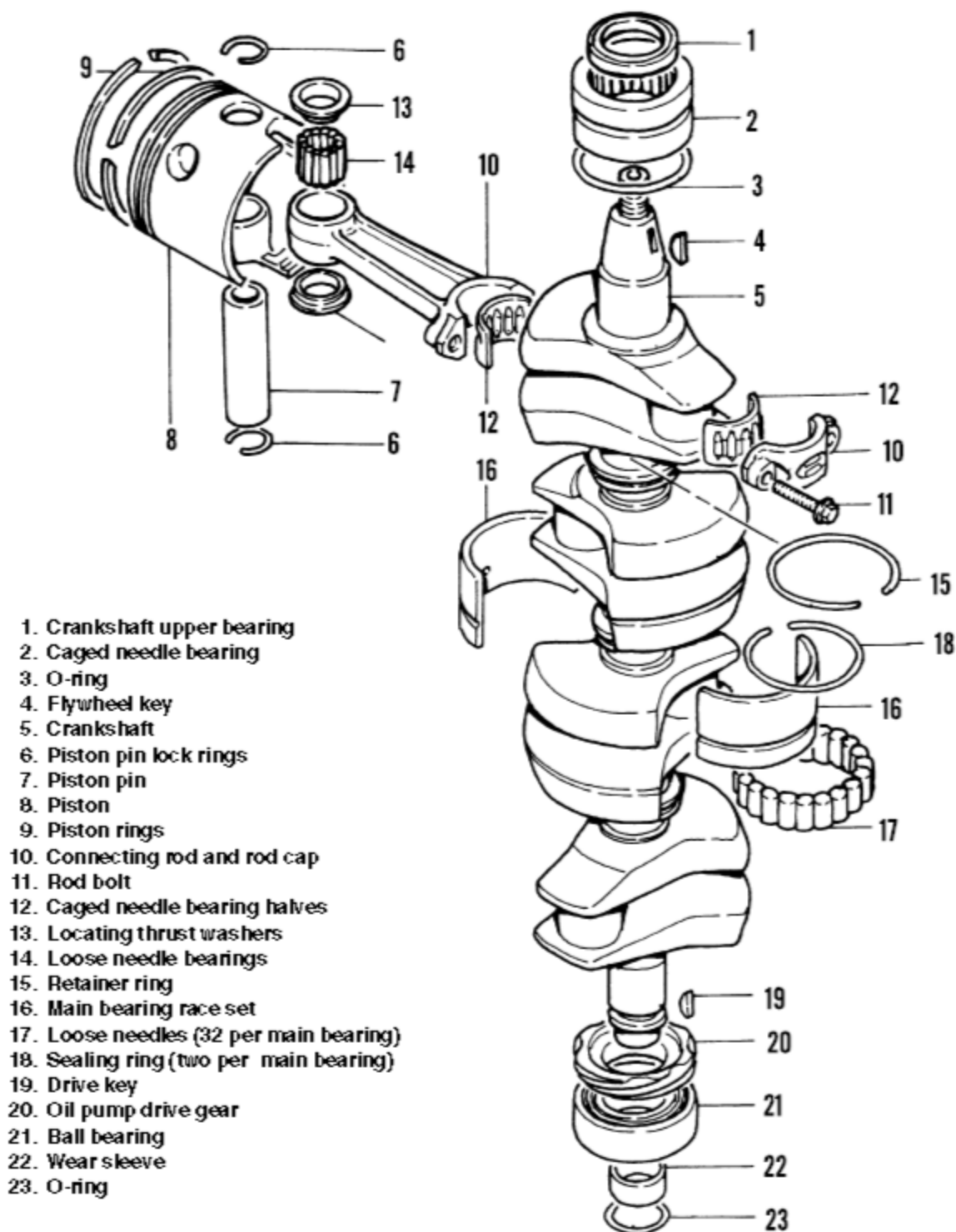

1. Crankshaft upper bearing
2. Caged needle bearing
3. O-ring
4. Flywheel key
5. Crankshaft
6. Piston pin lock rings
7. Piston pin
8. Piston
9. Piston rings
10. Connecting rod and rod cap
11. Rod bolt
12. Caged needle bearing halves
13. Locating thrust washers
14. Loose needle bearings
15. Retainer ring
16. Main bearing race set
17. Loose needles (32 per main bearing)
18. Sealing ring (two per main bearing)
19. Drive key
20. Oil pump drive gear
21. Ball bearing
22. Wear sleeve
23. O-ring